

Trouble Shooting



No visible bubbles	<ul style="list-style-type: none"> • Check power source • Remove rubber plug
Light blinks when operating unit	<ul style="list-style-type: none"> • Low battery indicator • Charge Unit battery soon
Low PPM levels when tested with H2 Blue Drops	<ul style="list-style-type: none"> • Allow 7 days to break-in • Keep generator wet. • Do not stir after each drop • Fill bottle to maximum
Wetness in Generator	<ul style="list-style-type: none"> • Units are shipped wet
Battery not charging	<ul style="list-style-type: none"> • Check if cable is defective
Unit is leaking water	<ul style="list-style-type: none"> • Check all seals, tighten cap • Empty waste chamber • Check if missing washers
Bottle has odor or Unit makes less gas	<ul style="list-style-type: none"> • Run Cleaning cycle • Taste/smell water source
Unit stopped working	<ul style="list-style-type: none"> • Call For Warranty Support
Glass bottle broke	<ul style="list-style-type: none"> • Order replacement Online
Unit stops charging	<ul style="list-style-type: none"> • Test Cable, Call For Support
Water leaks at top rim of bottle cap	<ul style="list-style-type: none"> • Leave air space between water level and bottle cap
For All Other or Any Unsolved Problem Call For Support	

CALL US: 860-806-9997

7 days a week 9 am - 9 pm EST

Or visit website: www.H2WaterforLife.com

H2WaterForLife.com



Global Leader in Hydrogen Water Makers

H2 USB Sport PRO II

You're Going To Like The Way You Feel!



H2 Water For Life

Email: info@H2WaterforLife.com Tel: 860-806-9997

www.H2WaterForLife.com

124 Litchfield Rd. Morris, Ct. 06763 USA

Most Advanced, Safe and Effective Hydrogen Water Making Technology

Disclaimer: Product is not intended to diagnose, cure, treat or prevent disease. Seek medical advice if ill.

- Never operate Generator without water in the bottle.
- Keep USB Port sealed by keeping its cover in place.
- Generator is shipped wet, remove plug before using.
- Operate only with any type of potable drinking water.
- Not for use with hot, carbonated or other beverages.
- Always keep Generator moist by keeping cap on.
- Battery is charged when LED light stops blinking.
- Do not place Generator unit in a refrigerator or cooler.
- Do not soak or submerge Generator Base under water.
- Try to drink within 10 minutes of making H2 water.
- Do not store to drink later, it will dissipate quickly.
- To share water pour into a glass and drink in minutes.
- Check waste chamber daily and empty any water there.
- Use cold or room temperature water. Never use ice.
- Doing more than 2 timed cycles may cause leaking and will not increase hydrogen gas PPM saturation levels.
- Battery has limited life span and to prolong its life, drain the battery completely before recharging it.
- Keep away from children, Pets, Heat and Flames.
- Do not pull cable from wire or plug with wet hands.
- Call for product support if you have any questions.

WARRANTY: One Year Parts & Labor

- To Set Up:**
1. Wash glass bottle (2) and lid (1) with soap and warm water.
 2. Remove Gen. Base (4) from bag and unscrew Base Cover (7).
 3. Separate Adapter (3) from Cover (7) to remove and dispose of the rubber plug (8) from inside the rim of bottle Adapter (3).
 4. Attach bottle to Gen. Base (4) by first twisting bottle onto Adapter (3), then screw Adapter threaded-end into Plates (11).
 5. With bottle attached rinse out Plates (11) with warm water.
 6. Fill bottle to threads with drinking water and put Cap (1) on.
 7. Insert USB cable tip into back USB Port (10) and insert other cable USB end into the power plug and plug it into wall outlet.
 8. Charge battery 2 or more hours before operating machine.
 9. Battery charge will automatically shut off when fully charged.
- Power Button:**
- Power toggle switch (9) has 3 positions with a BEEPING alarm.
- a. Press Once: 5 Minute Cycle (Blue Light)
 - b. Press Twice: 7 Minute Cycle (Green Light)
 - c. Press Third time: Machine shuts off.
- To Operate:**
1. Press power button twice to start a 7 minute cycle. (GREEN)
 2. After 7 minute cycle ends we recommend repeating this 7 minute cycle again to saturate the H2 level for highest benefit.
 3. Unit Beeps and power shuts off at end of each timed cycle.
 4. Use 5 minute cycle to keep H2 water fresh while pausing.
 5. Remove bottle cap (1) and drink from bottle within minutes.

Advisories



Quick Start Guide



Sports Pro II

Contents

1. Bottle Cap
2. Glass Bottle
3. Bottle Adapter (1st)
4. Generator Base
5. Waste Chamber Knob
6. Oxygen/Ozone Valve
7. Base Travel Cover
8. Generator Plug (dispose)
9. Power Switch
10. USB Power Port (Under Flap)
11. Generator Plates
12. Waste Chamber with translucent bottom
13. USB Cable & Plug
14. Spare Washers
15. Bottle Adapter (2nd)

Accessories

13. USB Cable & Plug
14. Spare Washers
15. Bottle Adapter (2nd)

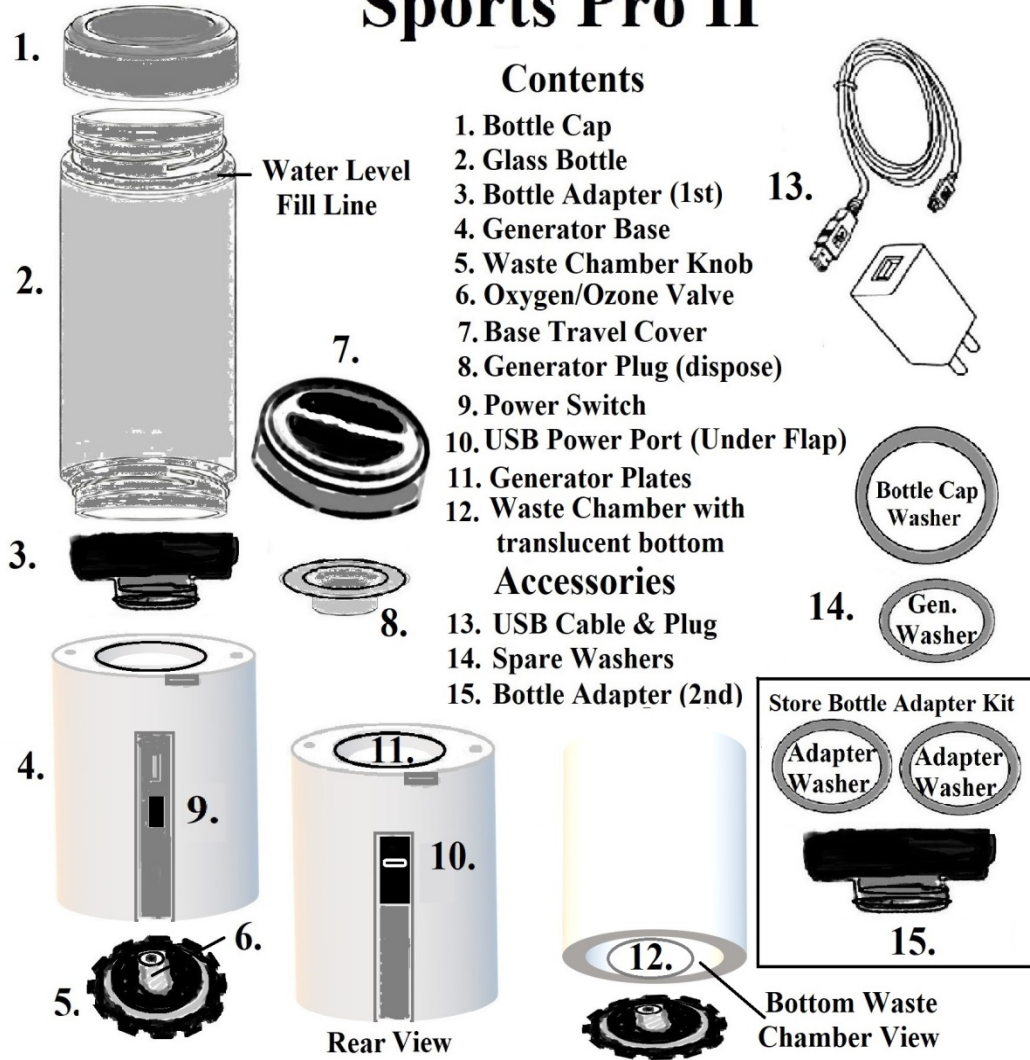

Store Bottle Adapter Kit Instructions

1. Travel Only with Base.
2. Fit 1 Adapter on bottle.
3. Twist Base on like cap.
4. Flip and Generate Gas up into store bottle.
(Flip back to remove base.)



Cleaning and Maintenance:

This unit is equipped with a Self-Cleaning mode feature that reverses the polarity of the Plates to produce Ozone gas as an effective cleaner and sterilizer to keep the unit clean and efficient to produce pure hydrogen gas into the water.

Cleaning Instructions:

1. Attach glass bottle to Generator and fill half full of water.
2. Start a 3 minute Self-Cleaning cycle by pressing and holding down the power button until the light turns purple and it beeps 10 times.
3. Allow 3 minute cycle to complete and shut off automatically and then dispose of this water and rinse out before using.

Cleaning Frequency:

If you drink purified filtered water, run cleaning cycle once a month. If you drink unfiltered tap water, run cleaning cycle once a week.

WARNING: ALWAYS DISPOSE OF WATER AND RINSE OUT THOROUGHLY AFTER CLEANING CYCLE IS FINISHED.

Inhaler Adapter Instructions

Note: Inhaling is a water substitute when drinking isn't practical. Use for plane and car trips or evenings. Always drink when possible.

1. Attach open end of cannula tube onto protruding pipe in center of round Inhaler Adapter bottle cap.
2. Fill bottle only $\frac{3}{4}$ full of water and screw onto bottle Inhaler Adapter cap.
3. Put tube loop over head and 2 tube prongs into nostrils and adjust snug the slack-bead behind the head or neck.
4. Press 7 min timer cycle and inhale. Repeat at will for 30 – 60 minutes or longer.

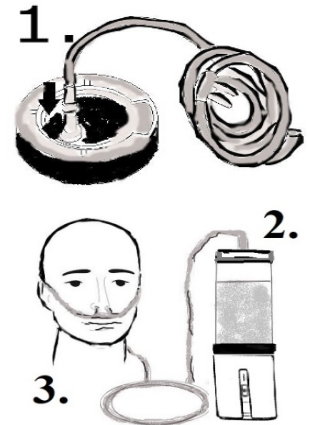

H2 USB SPORT PRO II SPECIFICATIONS	
POWER SUPPLY	USB 5V/ 110 – 230 VLT
BOTTLE CAPACITY	14 OZ / 400 ml (GLASS)
WATER REQUIRED	FOR ALL WATER TYPES
HYDROGEN PPM	0.8~1.0 (5 min) / 1.0~1.5 (7 min)
CLEANING TYPE	OZONE GAS
ORP RANGE	-350mv ~ -650mv